

5 Great Eastern House, Gas Ferry Road, City Centre, Bristol, Sold @ Auction £190,000



- FOR SALE BY PUBLIC AUCTION
- WEDNESDAY 18TH JULY
- ALL SAINTS CHURCH, CLIFTON, BS8 2HY
- WEEKLY SET VIEWINGS
- DOWNLOAD ONLINE LEGAL PACKS
- JULY 2018
- VACANT POSSESSION
- REDUCED PRICE FOR AUCTION
- SCOPE FOR £925 PCM
- EXTENDED 6 WEEK COMPLETION

Hollis Morgan JULY AUCTION - A modern SECOND FLOOR BALCONY APARTMENT (502 Sq Ft) on the HARBOURSIDE - with VACANT possession and REDUCED PRICE FOR AUCTION.

5 Great Eastern House, Gas Ferry Road, City Centre, Bristol, BS1 6GP

Accommodation

FOR SALE BY AUCTION

*** SOLD POST AUCTION ***

GUIDE £180,000 +++
SOLD @ £190,000

LOT NUMBER 21
Wednesday 18th July 2018
All Saints Church Pembroke Road, Clifton, Bristol BS8 2HY
Legal packs will be available for inspection from 18:00.
The sale will begin promptly at 19:00

EXTENDED COMPLETION

Completion is set for 6 weeks or earlier subject to mutual consent.

VIEWING

Viewings by appointment with Hollis Morgan
Contact George Harris - 0117 973 65 65

SOLICITORS

Tom Bowering
Wards
Tom.Bowering@wards.uk.com

ONLINE LEGAL PACKS

Digital Copies of the Online legal pack can be downloaded Free of Charge. Please visit the Hollis Morgan Website and select the chosen lot from our Current Auction List. Follow the RED link to "Download Legal Packs" For the first visit you will be required to register simply with your email and a password. Having set up your account you can download legal packs or if they are not yet available they will automatically be sent to you when we receive them. You will be automatically updated by email if any new information is added. There will be a note added to the list to confirm AUCTION PACK NOW COMPLETE when no further information is due to be added. *** STAY UPDATED *** By registering for the legal pack we can ensure you are kept updated on any changes to this Lot in the build up to the sale.

THE PROPERTY

A Contemporary second floor apartment (502 Sq Ft) completed in 2010 with balcony, located on Bristol's floating harbour. The apartment offers a modern kitchen area with integrated appliances. The lounge / diner is a good size and features a walk on balcony over looking the courtyard between buildings. The double bedroom is dual aspect with full-length window to one side of the room and further high-level window and built in wardrobe. There is a white bathroom suite with a tiled floor and a fitted wall mirror.

Lease - 140 years remaining
Ground rent - £300 pa
Management fee - £100 pcm

Floor plan

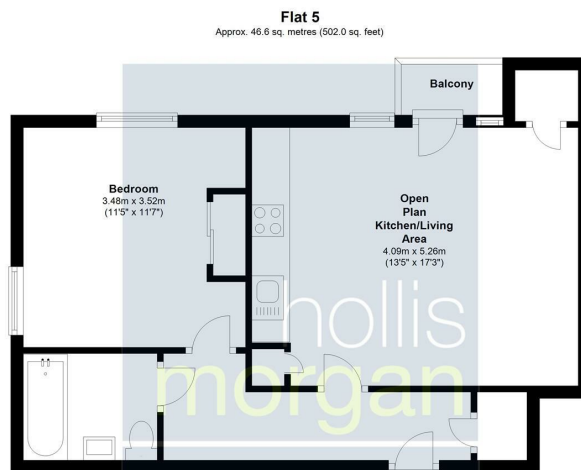

Total area: approx. 46.6 sq. metres (502.0 sq. feet)

Illustration for identification purposes only, measurements are approximate, not to scale.

Floorplan Produced by Westcountry EPC.
Plan produced using PlanUp.

Flat 5 Great Eastern House, Gas Ferry Road, Bristol

EPC Chart

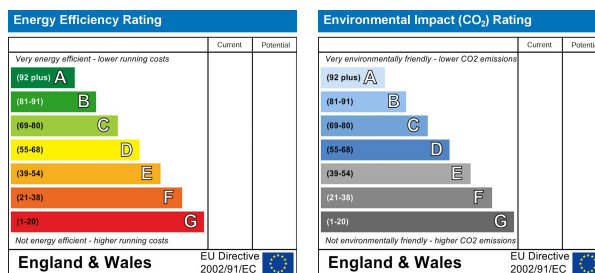

9 Waterloo Street
Clifton
Bristol
BS8 4BT
Tel: 0117 973 6565
Email: post@hollismorgan.co.uk
www.hollismorgan.co.uk

Hollis Morgan Property Limited, registered in England, registered 7275716.
Registered address, 5 Upper Belgrave Road, Clifton, Bristol BS8 2XQ